

NEC

D^{term}® Cordless Lite

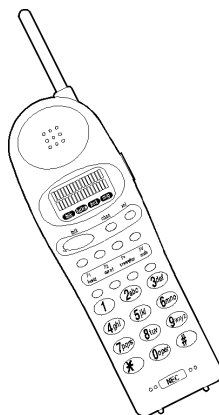

NEC America, Inc. reserves the right to change the specifications, functions, or features, at any time, without notice.

NEC America, Inc. has prepared this document for the use by its employees and customers. The information contained herein is the property of NEC America, Inc. and shall not be reproduced without prior written approval from NEC America, Inc.

D^{term} is a registered trademark of NEC America, Inc.

Copyright 1998

**NEC America, Inc.
1555 Walnut Hill Lane
Irving, TX 75038**

Business Terminals Division

Table of Contents

Chapter 1 Specifications and Safety Information

Section 1	Specifications	1-1
	General	1-1
	Base Unit	1-1
	Handset	1-1
	Battery Charger	1-2
Section 2	Battery Safety.....	1-2
Section 3	Important Safety Instructions	1-3
Section 4	Important Electrical Considerations	1-6
	Range	1-6
	Telephone Line Problems	1-6
	Radio Interference	1-7
	More than One Cordless Telephone	1-7

Chapter 2 About the Dterm Cordless

Section 1	Items Included with the <i>D^{term} Cordless Lite</i>	2-1
Section 2	Optional Accessories and Replacement Parts.....	2-2
Section 3	Features of the Cordless Telephone.....	2-2

Section 4	Handset Controls and Functions.....	2-4
Section 5	Base Unit Controls	2-5

Chapter 3 Installing the Dterm Cordless

Section 1	Selecting a Location.....	3-1
Section 2	Connecting the Telephone Cords	3-1
Section 3	Applying Power to the Charging Unit	3-3
Section 4	Wall Installation	3-5
	Standard Wall Plate Mounting	3-5
	Direct Wall Mounting	3-7
	Charging Unit Wall Mounting	3-9
Section 5	Attaching the Belt Clip to the Handset	3-11
Section 6	Installing the Handset Battery Pack	3-12
Section 7	Charging Batteries	3-14
	Charging the Handset Battery Pack	3-14
	Charging Spare Battery Packs	3-15
	Low Battery Indicator	3-16
	Cleaning the Battery Charge Contacts	3-17
Section 8	Antenna.....	3-17

Chapter 4 Dterm Cordless Handset

Section 1	Handset Controls	4-1
Section 2	Using the Handset.....	4-3
Section 3	Answering a Call	4-4
Section 4	Using the NEC Multiline Terminal	4-6
	Programming Mode	4-6
	Switching Between the <i>D^{term} Cordless Lite</i> and the Multiline Terminal	4-7
	Completing a Call using the NEC Digital Multiline Terminal	4-8
Section 5	Making a Call Using the <i>D^{term} Cordless Lite</i>	4-8
	Making a Normal Call	4-8
Section 6	Dedicated Feature Operations	4-9
	Placing a Call on Hold	4-10
	Muting a Call	4-10
	Transferring Calls	4-10
	Setting up a Conference Call	4-11
	Locking and Unlocking the Keypad	4-11

Chapter 5 Optional Equipment Installation

Section 1	Installing the Optional Headset (EXP9530).....	5-1
-----------	--	-----

Chapter 6 Troubleshooting

List of Figures

Figure 2-1	Items Included with the <i>D^{term} Cordless Lite</i>	2-1
Figure 2-2	Optional Accessories and Replacement Parts	2-2
Figure 2-3	Handset Controls and Functions	2-4
Figure 2-4	Base Unit Controls	2-5
Figure 3-1	Connecting Telephone Cords to the Telephone Jack	3-2
Figure 3-2	Connecting the Dterm Cordless Lite to the Multiline Terminal	3-2
Figure 3-3	Applying Power to the Charging Cradle	3-3
Figure 3-4	Polarized Plug	3-4
Figure 3-5	Attaching the Wall Mount Stand to the Base Unit	3-5
Figure 3-6	Placing the AC Adapter Cord Inside the Wall Mount Stand ...	3-5
Figure 3-7	Placing the Base Unit on the Posts of the Wall Plate	3-6
Figure 3-8	Plugging the AC Adapter into the AC Wall Outlet	3-6
Figure 3-9	Inserting Screws into the Wall for Wall Mounting the Telephone	3-7

Figure 3-10	Placing the Telephone Cords into Inside the Wall Mount Stand	3-8
Figure 3-11	Attaching the Wall Mount Unit to the Wall	3-8
Figure 3-12	Inserting Screws for Wall Mounting	3-9
Figure 3-13	Wrapping the AC Adapter Cord around the Strain Relief	3-10
Figure 3-14	Placing the Charging Unit on the Wall	3-10
Figure 3-15	Removing the Tab to Expose the Belt Clip Notch	3-11
Figure 3-16	Attaching the Belt Clip to the Handset	3-11
Figure 3-17	Removing the Belt Clip	3-12
Figure 3-18	Removing the Battery Cover	3-12
Figure 3-19	Replacing the Battery Pack	3-13
Figure 3-20	Replacing the Battery Cover	3-13
Figure 3-21	Charging Unit	3-14
Figure 3-22	Charging the Battery Pack	3-15
Figure 3-23	Battery Low Indicator	3-16
Figure 3-2	Cleaning Battery Charge Contacts	3-17
Figure 4-1	Handset Controls	4-1
Figure 4-2	Acquiring Link	4-3
Figure 4-3	Standby Mode	4-3
Figure 4-4	No Service	4-4

Figure 4-5 Cordless and Desk Buttons 4-7

Figure 4-6 Special Operations Keys 4-9

Figure 5-1 Installing the Headset 5-1

List of Tables



Table 3-1	Low Battery	3-16
Table 4-1	Handset Control Functions	4-1
Table 6-1	Troubleshooting	6-1

Specifications and Safety Information

SECTION 1 SPECIFICATIONS

The *D^{term} Cordless Lite* complies with FCC parts 15 and 68.

General

Frequency Control	Phase Lock Loop
Modulation	MFK
Operating Temperature	-10° ~ +50° C

Base Unit

Receive/Transmit Frequency	902 MHz ~ 928 MHz
Power Requirements	10V DC from supplied AC adapter
Size	4-1/4 in. W x 7-1/2 in. D x 2-1/4 in. H
Weight	Approximately 15.4 oz.

Handset

Receive/Transmit Frequency	902 MHz ~ 928 MHz
Power Requirements	Rechargeable sealed lead-acid battery pack.

Size	2-1/4 in. W x 1-1/2 in. D x 8-1/2 in. H (with antenna)
Weight	Approximately 8.8 oz with battery
Battery	Capacity 500 mAh, 4.0V
Talk Mode	5 hours (typical)
Standby Mode	40 hours (typical)

Specifications shown are typical and subject to change without notice.

Battery Charger

Power Requirements	9V DC from supplied AC adapter
Size	3-1/2 in. W x 4-3/4 in. D x 3-1/4 in. H

SECTION 2 BATTERY SAFETY

Battery Warning!

This equipment contains a rechargeable sealed lead-acid battery.

Do not short-circuit the battery.

Do not charge the rechargeable sealed lead-acid battery used in this equipment in any charger other than the one designed to charge this battery as specified in this manual. Using another charger can damage the battery or cause the battery to explode.



The exclamation point is used to alert the user of the presence of important operating and maintenance (servicing) instructions in this document.

SECTION 3 IMPORTANT SAFETY INSTRUCTIONS

When using the telephone equipment, basic safety precautions should always be followed to reduce the risk of fire, electrical shock, and injury to persons, including the following:

1. Read and understand all instructions.
2. Follow all warnings and instructions marked on the product.
3. Unplug this product from the wall outlet before cleaning. **Do not** use liquid cleaners or aerosol cleaners. Use a dry cloth for cleaning.
4. **Do not** use this product near water; for example, near a sink or in a wet area.
5. **Do not** place this product on an unstable cart, stand, or table. The telephone can fall, causing serious damage to the unit.
6. To protect the product from overheating, do not block or cover any slots or openings in the base unit. This product should never be placed near or over a radiator or heat register. This product should not be placed in a built-in installation unless the proper ventilation is provided.
7. This product should be operated only from the type of power source indicated on the marking label.
8. **Do not** allow anything to rest on the power cord. Do not locate this product where the cord will be damaged by persons walking on it.
9. **Do not** overload wall outlets and extension cords, as this can result in the risk of fire or electrical shock.

10. Never push objects of any kind into this product through the base unit slots, as they may touch dangerous voltage points or short out parts that could result in a risk of fire or electrical shock. Never spill liquid of any kind on the product.
11. To reduce the risk of electric shock, do not disassemble this product. Contact qualified service personnel when some service or repair work is required. Opening or removing covers may expose you to dangerous voltages or other risks. Incorrect reassembly can cause electric shock when the appliance is subsequently used.
12. Unplug this product from the wall outlet and refer servicing to qualified service personnel under the following conditions:
 - When the power supply cord is damaged or frayed.
 - If liquid has been spilled onto the product.
 - If the product has been exposed to water or rain.
 - If the product does not operate normally when following the operating instructions. Adjust only those controls that are covered by the operating instructions. Improper adjustment of other controls can result in damage, and will often require extensive work by a qualified technician to restore the product to normal operation.
 - If the product has been dropped, or the cabinet has been damaged.
 - If the product exhibits a distinct change in performance.
13. **Do not** use the telephone to report a gas leak in the vicinity or the leak.

Caution:

To reduce the risk of fire or injury to persons by the battery, read and follow these instructions.

1. Use only the appropriate type and size battery pack specified in the manual.
2. **Do not** dispose of the battery pack in a fire, the cell may explode.
3. **Do not** open or mutilate the battery pack. Released electrolyte is corrosive and can cause damage to the eyes or skin. It may be toxic if swallowed.
4. Exercise care in handling the battery in order not to short the battery with conducting materials such as rings, bracelets, and buttons. The battery or conductor can overheat and cause burns.
5. Charge the battery pack provided with or identified for use with this product only in accordance with the instructions and limitations specified in the instruction manual provided for this product.
6. Observe proper polarity orientation between the battery pack and battery charger.

Privacy

Cordless telephones are radio devices. Communications between the handset and base of the cordless telephone are accomplished by means of radio waves which are broadcast over the open airways. Because of the inherent physical properties of radio waves, communication can be received by radio receiving devices other than your own telephone unit, consequently, any communications using the cordless telephone may not be private.

SECTION 4 IMPORTANT ELECTRICAL CONSIDERATIONS

Warning!

Do not attempt to unplug any appliance during an electrical storm.

Unplug all electrical appliances when you know an electrical storm is approaching. Lightning can pass through your household wiring and damage any device connected to it. This telephone is no exception.

Caution:

Changes or modifications to this product not expressly approved by NEC America, Inc., or operation of this product in any way other than as detailed by this manual, could void your authority to operate this product.

Range

The new telephone is designed to achieve a maximum range of up to 150 feet (depending upon the environment) by transmitting and receiving according to the highest specifications set forth by the FCC. We have rated this phone to operate at a maximum distance with the qualification that the range depends upon the environment in which the telephone is used. Many factors limit range, and it would be impossible to include all of the variables in our rating. The maximum range rating of this telephone is meant to be used as a means of comparison against other range claims.

Telephone Line Problems

The FCC has granted the telephone company the right to disconnect service in the event that your telephone causes problems on the telephone line. Also, the telephone company may make changes in facilities and services which can affect the operation of your unit. However, your telephone company must give adequate notice in writing prior to such actions to allow you time for making necessary arrangements to continue uninterrupted service.

If you are having trouble with your telephone service, you must first disconnect your telephone to determine if it is the cause of your problem. If you determine that it is the cause, you must leave it disconnected until the trouble has been corrected.

Radio Interference

Radio interference may occasionally cause buzzing and humming in your cordless handset, or clicking noises in the base unit. This interference is caused by external sources such as TV, fluorescent lighting, or electrical storm. Your unit is NOT DEFECTIVE. If these noises continue and are too distracting, check around your office to see what appliances may be causing the problem. In addition, we recommend that the base not be plugged into a circuit that also powers a major appliance because of the potential of interference. For best performance, ensure that the antenna on the base unit is fully extended.

In the unlikely event that you consistently hear other voices or distracting transmissions on your telephone, you may be receiving radio signals for another cordless telephone or other source of interference. If you cannot eliminate this type of interference, you need to change to a different channel.

Finally, it should be noted that some cordless telephones operate at frequencies that may cause interference to nearby TVs and VCRs. To minimize or prevent such interference, the base of the cordless telephone should not be placed near or on top of a TV or VCR. If interference is experienced, moving the cordless telephone farther away from the TV or VCR will often reduce or eliminate the interference.

More than One Cordless Telephone

If you want to use more than one cordless telephone in your office, they must operate on different channels. Press the channel key to select a channel that provides the clearest communication.

About the *D^{term}* *Cordless*

SECTION 1 ITEMS INCLUDED WITH THE *D^{term}* *Cordless Lite*

Congratulations on your purchase of the *D^{term}* *Cordless Lite*. This telephone is designed and engineered to exacting standards for reliability, long life, and outstanding performance. To become familiar with the features of the cordless telephone, read this manual thoroughly.

The *D^{term}* *Cordless Lite* includes the following items:

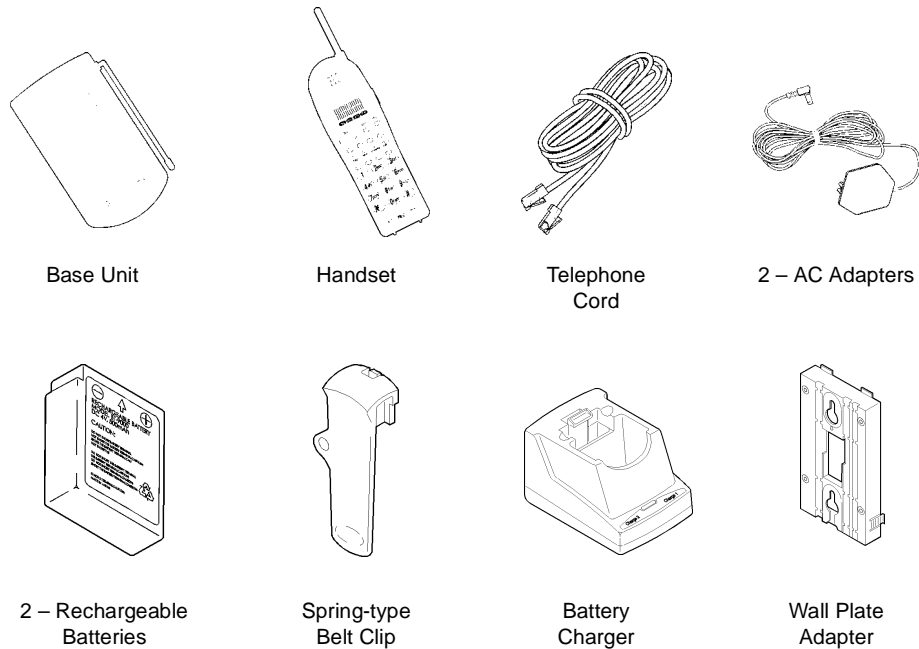

Figure 2-1 Items Included with the *D^{term}* *Cordless Lite*

SECTION 2 OPTIONAL ACCESSORIES AND REPLACEMENT PARTS

Optional accessories and replacement parts can be obtained by contacting your NEC Dealer.

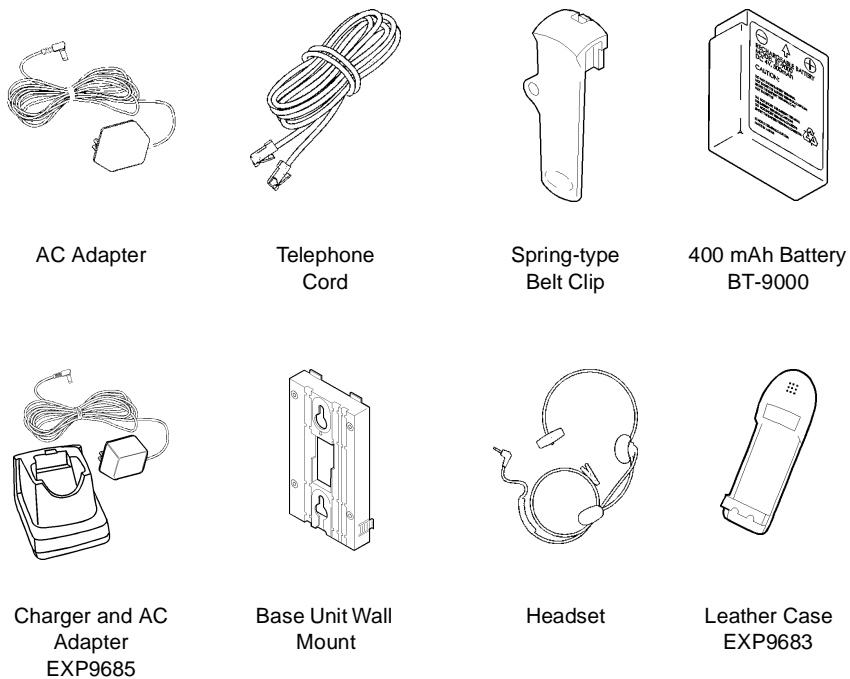

Figure 2-2 Optional Accessories and Replacement Parts

SECTION 3 FEATURES OF THE CORDLESS TELEPHONE

The *D^{term} Cordless Lite* telephone provides a variety of features. These features are listed below.

900 MHz Digital

2-line, 16-digit LCD Display

Headset Jack

Channel Selection Control

Ringer Volume Control

Handset Volume Control

Single Key Access to: Conference, Hold, Transfer, and Mute features

Four Programmable Keys: F1~F4

Separate Charging Stand with Spare Battery Charging Capability

Second Spare Battery

AutoStandby

AutoTalk

Silent Alarm

Out of Range Protection

Low Battery Protection System

Key Pad Lock Feature

Wall Mountable Separate Base Unit

Wall Mountable Separate Charging Unit

Easy Installation

Compact Handset Design

Use with an NEC Digital Multiline Terminal * or as a stand-alone device

- * The *D^{term} Cordless Lite* can be used in conjunction with the Electra Professional, Electra Elite, D^{term} Series III and D^{term} Series E digital Multiline Terminals.

SECTION 4 HANDSET CONTROLS AND FUNCTIONS

Figure 2-3 Handset Controls and Functions identifies the functions of the cordless telephone handset.

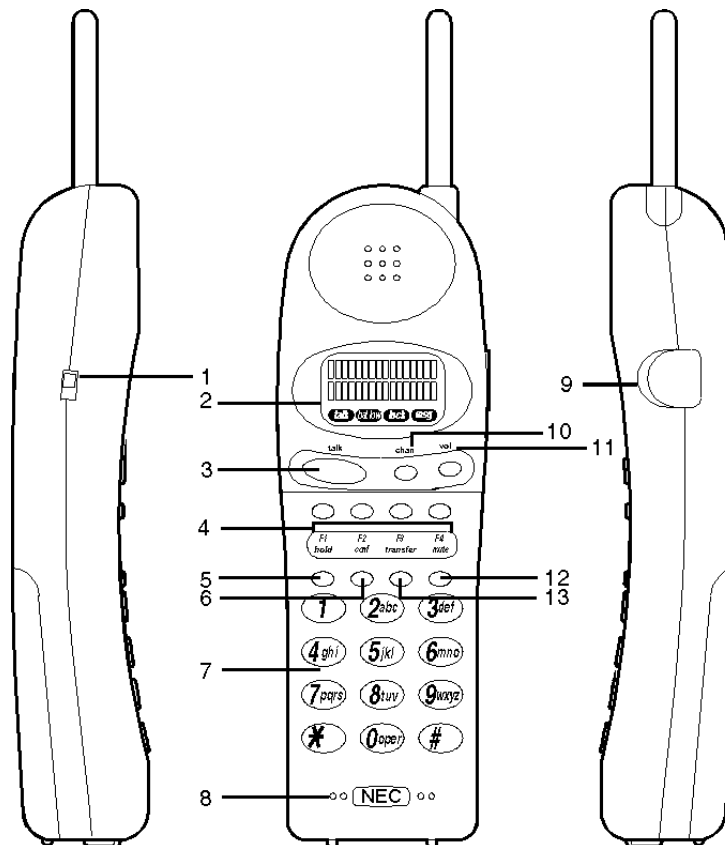

- | | |
|-----------------------------------|--------------------------------------|
| 1. Ringer ON/OFF Switch | 8. Microphone |
| 2. LCD/Icons | 9. Handset Jack |
| 3. Talk Key (<i>talk</i>) | 10. Channel Key (<i>chan</i>) |
| 4. Function Keys F1~F4 | 11. Volume Key (<i>vol</i>) |
| 5. Hold Key (<i>hold</i>) | 12. Mute Key (<i>mute</i>) |
| 6. Conference Key (<i>conf</i>) | 13. Transfer Key (<i>transfer</i>) |
| 7. Dial Pad | |

Figure 2-3 Handset Controls and Functions

SECTION 5 BASE UNIT CONTROLS

Figure 2-4 Base Unit Controls identifies the controls of the telephone base unit.

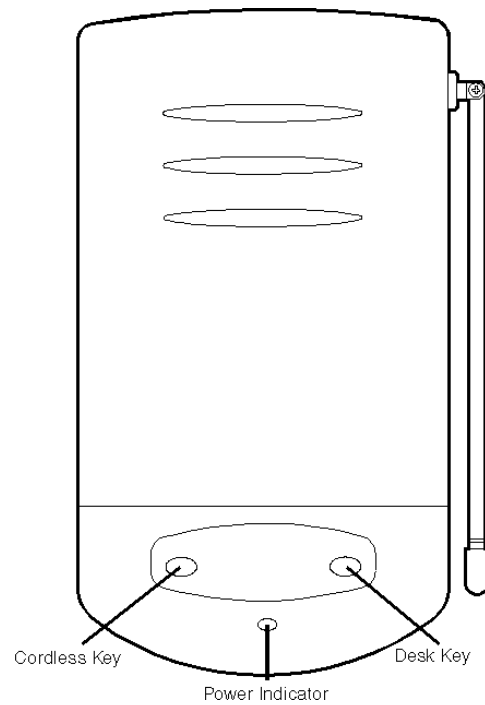

Figure 2-4 Base Unit Controls

Installing the D^{term} Cordless

SECTION 1 SELECTING A LOCATION

Select a location for the *D^{term} Cordless Lite* to avoid excessive heat or humidity. The base unit of the *D^{term} Cordless Lite* can be placed on a desk or tabletop near a standard 120 Vac outlet and telephone line jack. The base unit can also be mounted on a standard AT&T or GTE wall plate using the wall mount adapter. Keep the base unit and handset away from sources of electrical noise (motors, fluorescent lighting, computers, PC monitor). Refer to [Chapter 1 Specifications and Safety Information](#) for a complete discussion of safety precautions.

SECTION 2 CONNECTING THE TELEPHONE CORDS

When connecting the telephone cords, observe the following precautions.

Never install telephone wiring during a lightning storm.

Never touch bare telephone wires or terminals unless the telephone line has been disconnected at the network interface.

Use caution when installing or modifying telephone lines.

1. Connect the cord from the telephone jack to the Line In on the *D^{term} Cordless Lite*.

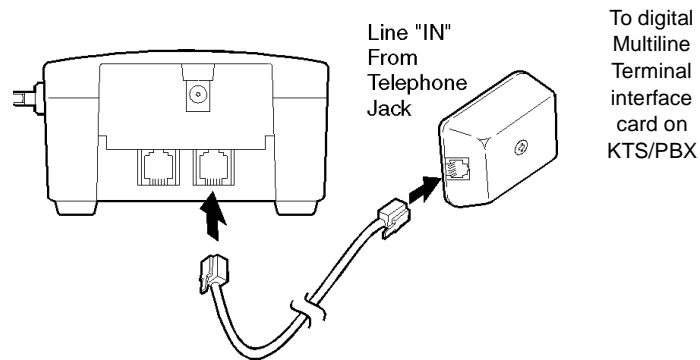

Figure 3-1 Connecting Telephone Cords to the Telephone Jack

2. Connect a qualified NEC digital Multiline Terminal to the *D^{term} Cordless Lite*.

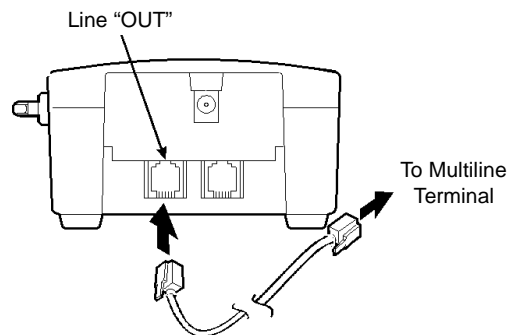

Figure 3-2 Connecting the *D^{term} Cordless Lite* to the Multiline Terminal

SECTION 3 APPLYING POWER TO THE CHARGING UNIT

The unique design of the telephone allows the user to place the handset in the charging unit with or without the belt clip attached. The charging unit can charge a second battery with or without the handset being charged. The battery packs can automatically be recharged either in or out of the handset.

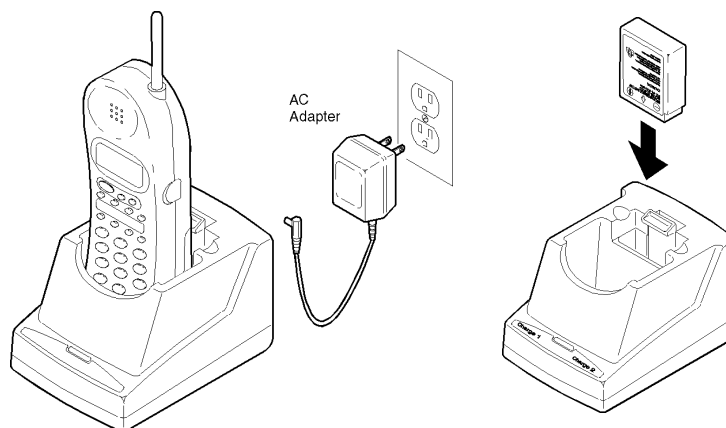

Figure 3-3 Applying Power to the Charging Cradle



Use only the supplied AC adapter for the charging unit.

The AC adapter furnished with this telephone may be equipped with a polarized line plug (a plug having one blade wider than the other). This plug will fit into the power outlet only one way. If you are unable to insert the plug fully into the outlet, try reversing the plug. Refer to [Figure 3-4 Polarized Plug](#).

If you cannot plug the AC adapter into the outlet, the outlet may need to be replaced.

Important! – Route the power cord where it will not create a trip hazard, or where it could become chafed and create a fire or other electrical hazards.

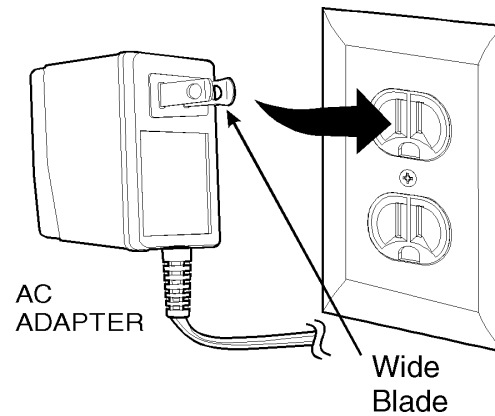

Do not alter the shape of the blades of the polarized plug.

Figure 3-4 Polarized Plug

SECTION 4 WALL INSTALLATION

Standard Wall Plate Mounting

The base unit is designed to be mounted on standard AT&T or GTE wall plate. To attach the wall mount stand to the base unit:

1. Slide the wall mount stand into the notches at the top of the base unit. Rotate the wall mount stand down and snap it into place.

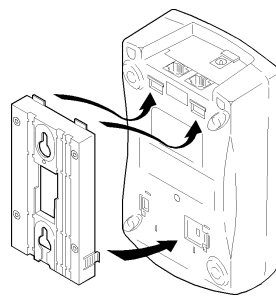

Figure 3-5 Attaching the Wall Mount Stand to the Base Unit

2. Plug the AC adapter into the base unit.
3. Place the AC adapter cord inside the molded channel of the wall mount stand.

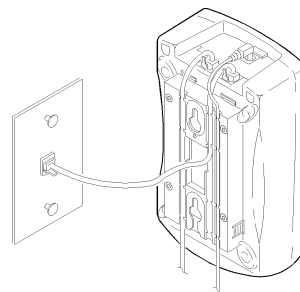

Figure 3-6 Placing the AC Adapter Cord Inside the Wall Mount Stand

4. Plug one end of the short telephone cord (locally supplied) in the **LINE** jack on the base unit. Plug one end of the NEC digital Multiline Terminal into the **PHONE** jack. Place the telephone cords inside the molded channels on the bottom of the wall mount stand.
5. Plug the other end of the short telephone cord into the modular wall jack in the center of the wall plate.
6. Place the base unit on the posts of the wall plate and push down until it is firmly seated.

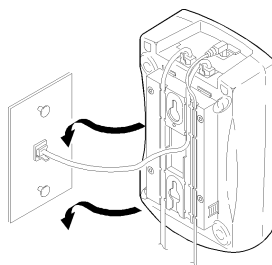

Figure 3-7 Placing the Base Unit on the Posts of the Wall Plate

7. Plug the AC adapter into a standard 120 Vac wall outlet.
Note: Do not use an outlet controlled by a wall switch.

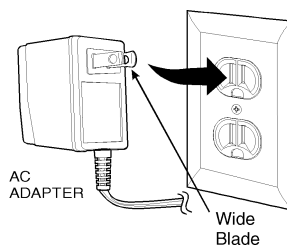

Figure 3-8 Plugging the AC Adapter into the AC Wall Outlet

Direct Wall Mounting

If a standard wall plate is not available, mount the telephone directly on the wall. Before mounting the telephone, consider the following:

Select a location away from electrical cables, pipes, or other items behind the mounting location that could cause a hazard when inserting screws into the wall.

Make sure the wall material is capable of supporting the weight of the base unit.

Use #10 screws with anchoring devices suitable for the wall material where the base unit will be placed.

To mount the telephone:

1. Insert two mounting screws 3-15/16 inches apart. Allow about 3/16 of an inch between the wall and screw heads for mounting the telephone.

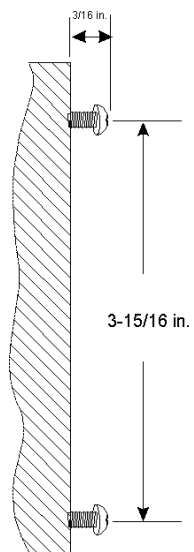

Figure 3-9 Inserting Screws into the Wall for Wall Mounting the Telephone

2. Plug and secure the AC adapter.
3. Plug the AC adapter into the base unit.
4. Plug one end of the short telephone cord into the **LINE** jack on the base unit. Then plug one end of an Electra Professional or Electra Elite Multiline Terminal into the **PHONE** jack. Place the telephone cords inside the molded channels on the bottom of the wall mount stand.

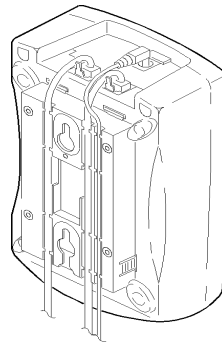

Figure 3-10 Placing the Telephone Cords into Inside the Wall Mount Stand

5. Place the base unit on the posts of the wall screws and push down until it is firmly seated.

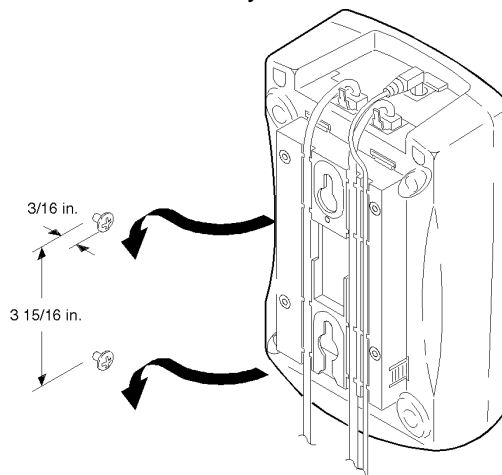

Figure 3-11 Attaching the Wall Mount Unit to the Wall

6. Plug the other end of the short telephone cord into a telephone wall jack.
7. Plug the AC adapter into a standard 120 Vac wall outlet. Refer to [Figure 3-8 Plugging the AC Adapter into the AC Wall Outlet on page 3-6](#).

Note: Do not use an outlet controlled by a wall switch.

Charging Unit Wall Mounting

The charging unit is also designed to be wall mounted. Before mounting the charging unit, consider the following:

Select a location away from electrical cables, pipes, or other items behind the mounting location that could cause a hazard when inserting screws into the wall.

Make sure the wall material is capable of supporting the weight of the charging unit.

Use #10 screws with anchoring devices suitable for the wall material where the charging unit will be placed.

1. Insert two mounting screws one inch apart. Allow about $\frac{3}{16}$ of an inch between the wall and screw heads for mounting the telephone.

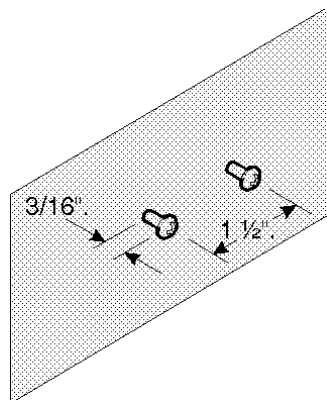

Figure 3-12 Inserting Screws for Wall Mounting

2. Plug the AC adapter into the charging unit. Wrap the AC adapter cord around the strain relief.

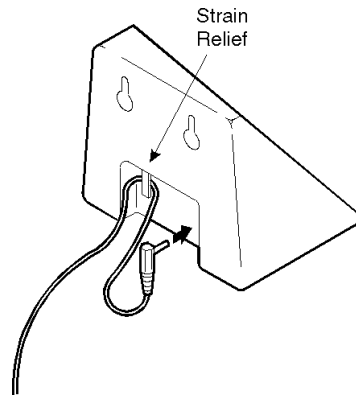

Figure 3-13 Wrapping the AC Adapter Cord around the Strain Relief

3. Place the charging unit on the posts of the wall screws and push down until it is firmly seated.

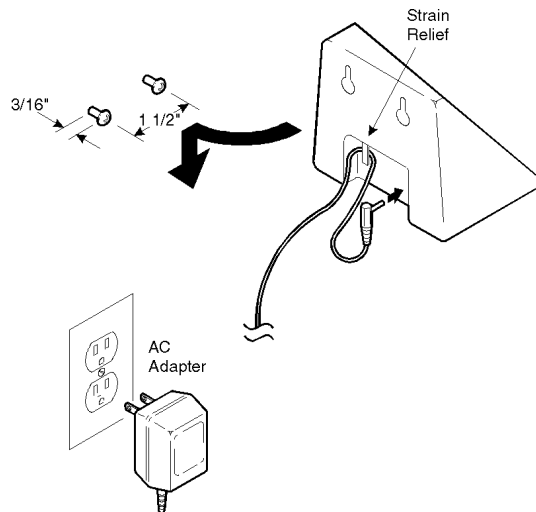

Figure 3-14 Placing the Charging Unit on the Wall

4. Plug the AC adapter into a standard 120 Vac wall outlet. Refer to [Figure 3-14 Placing the Charging Unit on the Wall](#).

SECTION 5 ATTACHING THE BELT CLIP TO THE HANDSET

A belt clip can be used to attach the handset to a belt or pocket for convenient portability.

1. Snap the tab out of the belt clip notch on the top of the handset.

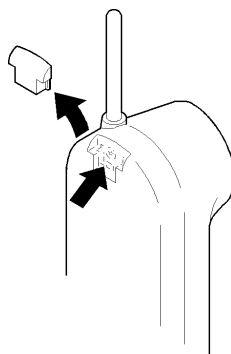

Figure 3-15 Removing the Tab to Expose the Belt Clip Notch

2. Slide the clip into the tab slot. Press firmly until it snaps into place. The belt clip is designed to fit snugly onto the handset.

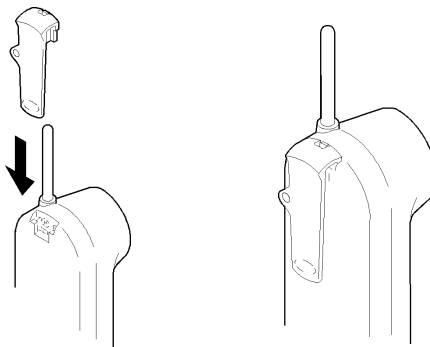

Figure 3-16 Attaching the Belt Clip to the Handset

3. To remove the clip, press the retaining clip in toward the belt clip blade and slide the clip up at the same time. Once the belt clip is removed, remember to reinstall the cover tab.

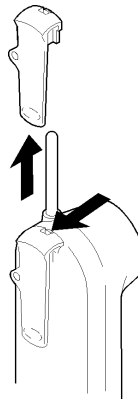

Figure 3-17 Removing the Belt Clip

SECTION 6 INSTALLING THE HANDSET BATTERY PACK

1. Remove the battery cover by pressing the latch and sliding the cover down and off of the handset.

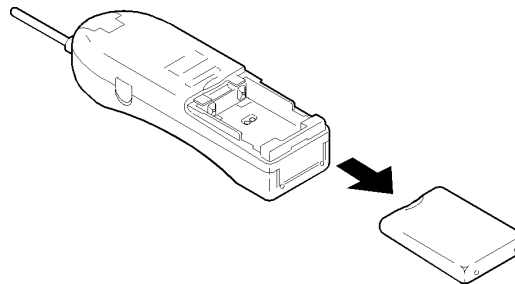

Figure 3-18 Removing the Battery Cover

2. Slide the battery pack down into the handset.

Note: It may be necessary to remove the old battery at this time.

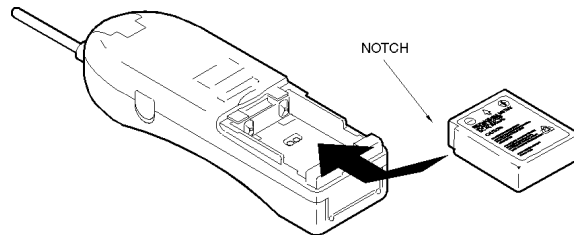

Figure 3-19 Replacing the Battery Pack

3. Place the cover and slide it up until it latches onto the handset.

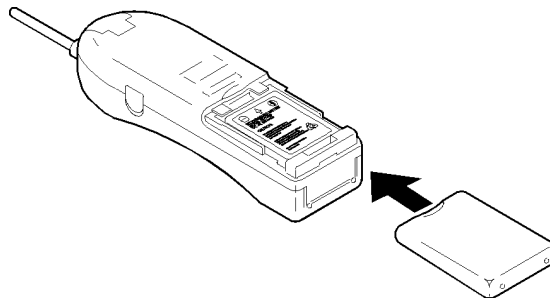

Figure 3-20 Replacing the Battery Cover

SECTION 7 CHARGING BATTERIES

Charging the Handset Battery Pack

The rechargeable battery pack must be fully charged before using the *D^{term} Cordless Lite* for the first time.

Note: Charge the battery pack without interruption for five to eight hours.

1. Place the handset in the front slot of the charging unit.
2. Make sure the CHARGE 1 indicator lights. If the CHARGE 1 LED does not come on, check to see if the AC adapter is plugged in and that the handset is making good contact with the charging contacts on the charging unit.

Note: The CHARGE 1 LED turns red during and after charging the handset with the battery.

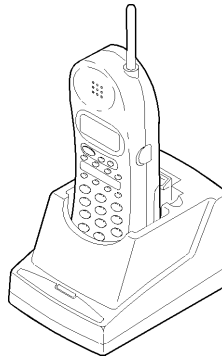

Figure 3-21 Charging Unit

Charging Spare Battery Packs

The *D^{term} Cordless Lite* is equipped with a battery charger for charging the spare battery pack.

1. Slide the spare battery pack into the second slot in the charging unit until the retaining clip snaps over the top of the pack.
2. Make sure the CHARGE 2 LED lights. If it does not light, check that the AC adapter is plugged in and that the battery pack is making contact with the charging contacts on the charging unit.

Charging is complete when the CHARGE 2 LED goes off.

Note: Charge the battery pack without interruption for five to eight hours.

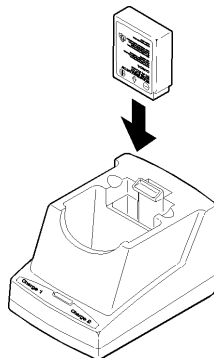

Figure 3-22 Charging the Battery Pack

3. When charging is complete, press out on the latch and remove the battery pack for use. If the battery pack is not needed immediately, leave it in the charging compartment (it will not overcharge).

Low Battery Indicator

When the Battery Pack in the handset is low and needs to be charged, the **batt low** message is displayed on the LCD.



Figure 3-23 Battery Low Indicator

Return the handset to the base unit for charging or replace the handset battery pack with another charged battery pack.

The following table indicates what occurs and the action to be taken during a call or in standby mode when low battery indication is displayed.

Table 3-1 Low Battery

On a Call	In Standby Mode
What occurs when batt low is displayed:	
Only the talk key operates	None of the keys operate
Handset beeps once every three seconds	Handset beeps every 15 seconds for 15 minutes
Action:	
Complete the call as quickly as possible	Cannot make a call
Replace the battery pack within 20 seconds to continue a call	Replace the battery pack before making another call

Cleaning the Battery Charge Contacts

To maintain a good charge, it is important to clean all charging contacts on the handset and charging unit about once a month. Use a pencil eraser or other contact cleaner. Do not use liquids or solvents.

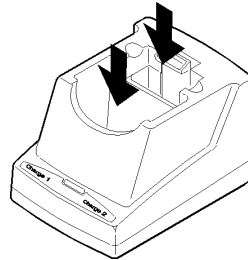

Figure 3-2 Cleaning Battery Charge Contacts

SECTION 8 ANTENNA

Before using the *D^{term} Cordless Lite*, raise the antenna to the vertical position.

D^{term} Cordless Handset

SECTION 1 HANDSET CONTROLS

The operations of the *D^{term} Cordless Lite* are performed using the handset. The **talk**, **chan** (channel), and **vol** (volume) keys are used to control various functions.

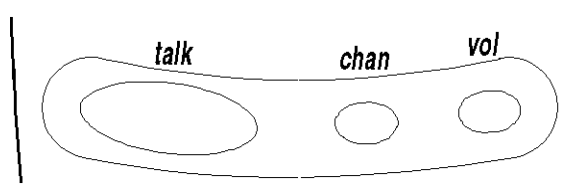

Figure 4-1 Handset Controls

[Table 4-1 Handset Control Functions](#) explains the handset controls.

Table 4-1 Handset Control Functions

Condition	Action	LCD Display
Talk Key (Standby Mode)	Press talk on the front of the handset to make a call. The telephone first acquires a line to the base.	The LCD display shows the text 'ACQUIRING LINK' in a rectangular box. Below this, there is a larger empty rectangular box. At the bottom left of the display area, there is a small icon of the 'talk' key.

Table 4-1 Handset Control Functions

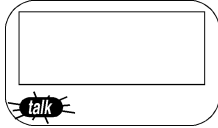
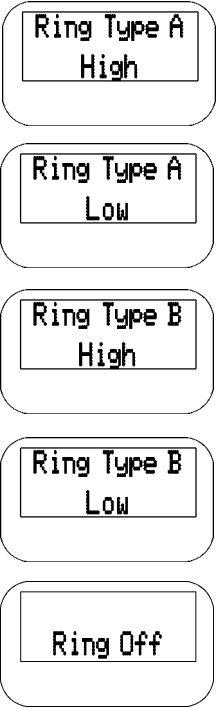
Condition	Action	LCD Display
Channel Key (during a call)	Press chan , the talk indicator flashes twice as the base unit switches to a different channel.	
Handset Receive Volume (during a call)	Press vol to select a high or low receive volume level. This function provides volume control to the handset or to an accessory headset.	No display indications
Ringer Select (Standby Mode)	Press vol on the front of the handset to select one of the following settings: Ring Type A (High) Ring Type A (Low) Ring Type B (High) Ring Type B (Low) Ring Off (Silent Alarm)	

SECTION 2 USING THE HANDSET

When the handset is picked up and *talk* is pressed, “Acquiring Link” is displayed.

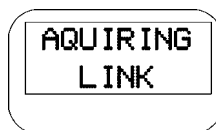

Figure 4-2 Acquiring Link

After the connection is made between the handset and base, one of the following is displayed in the LCD.

Condition	Indicator	LCD Display
Line OK	TALK Icon	
No Connection to Base Unit	Error Tone	NO SERVICE
Channel Busy	Error Tone	SYSTEM BUSY
Line in Use	Error Tone	LINE IN USE
No Line Selected	TALK Icon	NO LINE SELECTED

When communication is made between the base unit and the handset, the LCD is blank, and the telephone is ready to use.



Figure 4-3 Standby Mode

When the handset is at the range limit of the *D^{term} Cordless Lite*, a “No Service” message is displayed.

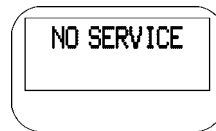

Figure 4-4 No Service

When “No Service” is received, take the following action:

	During a Call	In Standby Mode
Condition	Warning Tone	Cannot make or answer calls (telephone may ring intermittently).
Action	Move back in range within 20 seconds. Check power to the base unit.	Move back within range. Check power to the base unit.

SECTION 3 ANSWERING A CALL

To answer a call when the handset is in the charging unit:

1. When a call is received, the handset rings and the LED on one of the function keys (assigned to a line key) flashes.
2. Pick up the handset. The *AutoTalk* feature allows the call to be answered immediately.

3. When the call is finished, place the handset back in the charging unit. *AutoStandby* automatically hangs up the phone.

-OR-

If the handset is away from the charging unit, press **talk** to hang up the telephone.

To answer a call if the handset is not in the charging unit:

1. When a call is received, the handset rings and the red LED on one of the function keys flashes.
2. Press the function key with the flashing LED to answer the call.

-OR-

Press **talk** to answer the incoming call.

Note 1: The Ringing Line Preference feature must be enabled in order to answer calls with the **talk** key. Contact the authorized NEC Dealer to for programming this feature.

Note 2: If two or more calls come in at the same time, pressing the **talk** key answers the prime line.

3. When the call is finished, place the handset back on the charging unit. *AutoStandby* automatically hangs up the telephone.

-OR-

If the handset is away from the base unit, press **talk** to hang up the telephone.

SECTION 4 USING THE NEC MULTILINE TERMINAL

Programming Mode

To assign function keys (F1~F4) and off-hook ringing:

1. Press and hold down **k** and **#**, then press the **talk** key.
2. Press the **chan** key repeatedly to scroll through the line key (LK) and feature options for function key **F1**.
3. Press the **vol** key to select the displayed line key or feature.
4. If a Line Key has been assigned, press the **chan** key to turn Off-Hook Ringing ON or OFF. The LCD will indicate **/TALK** for ON or **/NO TALK** for OFF.
5. Press the **vol** key to advance to the next function key (**F2 ~ F4**).
6. After programming **F4**, press the **vol** key to advance to Global Off-Hook Ringing Assignment.
7. Press **chan** to turn Global Off-Hook Ringing ON/OFF (LCD indicates ON or OFF as appropriate).
8. Press the **talk** key to exit.

Note 1: Function keys (**F1 ~ F4**) can be programmed as Line Keys 1~16, Redial (LNR/SPD), Answer (ANS), Feature (FNC), or Recall. When assigned, these keys operate the same as on an NEC Multiline Terminal.

Note 2: When initially installed, function keys (**F1~F4**) default to Line Keys 1~4 respectively and Off-Hook Ringing defaults to ON.

Note 3: Global Off-Hook Ringing must be set to ON (default) if any function key is to operate with Off-Hook Ringing.

Switching Between the *D^{term} Cordless Lite* and the Multiline Terminal

When the *D^{term} Cordless Lite* is associated with a Multiline Terminal the following is applicable:

Switching between *cordless* and *desk* mode must be done while **both** terminals are idle.

A call in progress **cannot** be switched between the *D^{term} Cordless Lite* and the associated Multiline Terminal.

Switching held calls between the *D^{term} Cordless Lite* and the associated Multiline Terminal is not recommended since line key LED indications will not be provided.

Use the base unit on the *D^{term} Cordless Lite* to switch between the *D^{term} Cordless Lite* and the Multiline Terminal.

Press **Cordless** to select the *D^{term} Cordless Lite*.

-OR-

Press **Desk** to select the Multiline Terminal. (Refer to [Figure 4-5 Cordless and Desk Buttons](#).)

Note: The *D^{term} Cordless Lite* display indicates “DESK TEL” when the Multiline Terminal is connected.

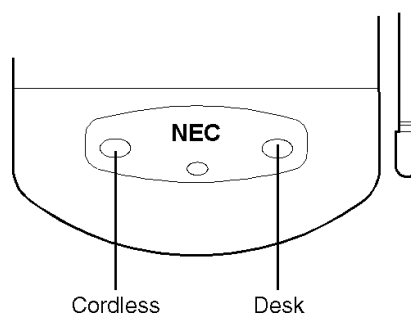

Figure 4-5 Cordless and Desk Buttons

Completing a Call using the NEC Digital Multiline Terminal

When a call is completed, hang up the host telephone.

SECTION 5 MAKING A CALL USING THE *D^{term} Cordless Lite*

Several advanced features for making calls are available depending on how the deskset is programmed. Refer to [Section 6 Dedicated Feature Operations](#). This section describes normal call handling.

Making a Normal Call

1. Remove the handset from the charging unit.
2. Press the **talk** key. The talk icon appears after the handset and base unit are connected.



-OR-

Press the designated function key (programmed as a line key). When dial tone is heard, enter the number to be called. The display shows the dialed telephone number.

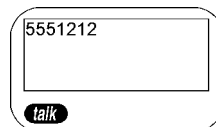

3. When the call is finished, place the handset back in the charging unit. The *AutoStandby* automatically hangs up the telephone.

-OR-

If the handset is away from the charging unit, press ***talk*** to hang up the telephone.

SECTION 6 DEDICATED FEATURE OPERATIONS

Calls can be placed on hold, transferred to another extension, or two or more parties can be conferenced. These operations depend upon how they are set up in the key system.

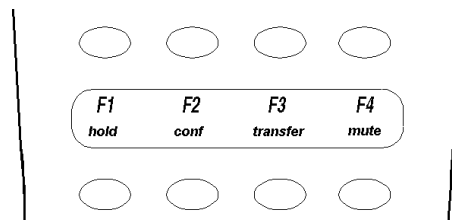

Figure 4-6 Special Operations Keys

Caution

The handset must be within range of the base for the special operations to function properly.

Placing a Call on Hold

1. Press **hold** on the handset during the call. The LED associated with the line key being used flashes.
2. To return to the holding call, press the associated line key.

Muting a Call

1. Press the **mute** key on the handset during a call. The talk icon blinks on the display.



2. To turn mute off, press the **mute** key again and the call is restored.

Transferring Calls

Calls can be forwarded to another extension. To transfer a call:

1. Press the **transfer** key and the phone number of the transfer destination.
2. Wait for the party to answer, then press the **talk** key to hang up. The two parties can now converse.

Setting up a Conference Call

This feature allows the user to set up a 3-party conference (the user and two other parties).

To set up the conference:

1. Dial the first number for the first party.
2. When the first party answers, press the **conf** key.
3. Dial the second number for the second party.
4. Press the **conf** key again. A 3-party conference is now established. If any party hangs up, the conference only includes the remaining parties.

Locking and Unlocking the Keypad

The *D^{term} Cordless Lite* can be locked so no outgoing calls can be made.

Locking the Keypad

To lock the telephone:

1. Press and hold the **chan** key for one second while in standby mode. A code input appears in the display.

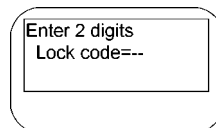

2. Enter a 2-digit number. The number is displayed.

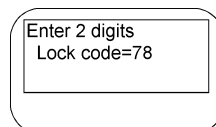

3. Press **chan** again. The LCD displays “Lock?”, and prompts the user to continue.

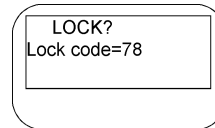

4. Press the **chan** key again to confirm the entry. The display is blank and the lock icon is displayed.

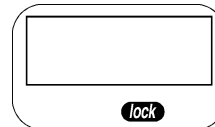

Unlocking the Keypad

1. Press and hold the **chan** key for one second while in standby mode. A code input and the lock icon appear in the display.

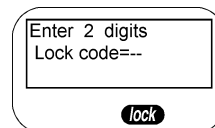

2. Enter the 2-digit number used to lock the telephone. The code appears in the display.

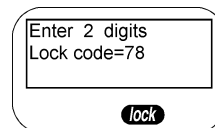

3. Enter the 2-digit lock code and press **chan**. If the number is entered correctly, a “beep” is heard and the LCD clears. The telephone goes into standby mode.

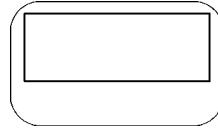

-OR-

If the 2-digit number is entered incorrectly, an error tone is heard when **chan** is pressed. The LCD clears but the lock icon remains on as the telephone goes into standby mode.

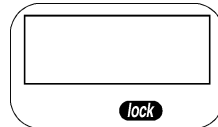

Optional Equipment Installation

An optional headset and backup AC adapter can be installed on the *D^{term} Cordless Lite* unit.

SECTION 1 INSTALLING THE OPTIONAL HEADSET (EXP9530)

The optional headset provides a handsfree option for the *D^{term} Cordless Lite*. With the headset installed, the user can use the belt clip to carry the handset and conduct a conversation using the headset.

To install the headset:

Open the cover over the headset jack and plug the headset into the receptacle.

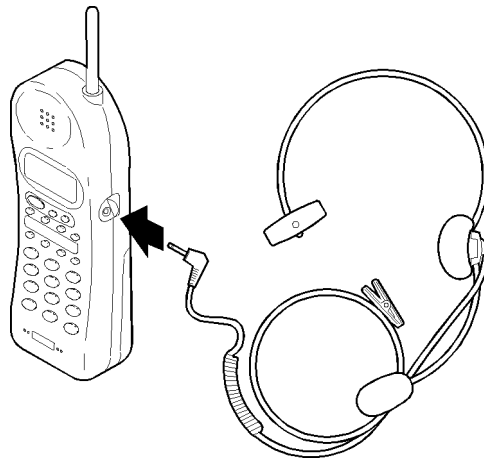

Figure 5-1 Installing the Headset

No other settings are needed. Operation of the headset is the same as the handset. However, the user hears through the headset earphone and talks through the headset microphone. The handset earphone and microphone (mouthpiece) are disconnected.

Troubleshooting

If the *D^{term} Cordless Lite* is not performing to your expectations, try these simple steps. If this does not resolve the problems, contact the NEC dealer.

Note: Do not attempt to service this unit yourself. All service must be done by qualified service personnel.

Table 6-1 Troubleshooting

Problem	Suggestion
Charge 1 light will not come on when the handset is placed in the charging unit.	<ul style="list-style-type: none">• Make sure the AC adapter is plugged into the charging unit and wall outlet.• Make sure the handset is properly seated in the charging unit.• Make sure the lead-acid battery pack is properly placed on the handset.• Make sure that the charging contacts on the handset and charging unit are clean.
Charge 2 light will not come on when the spare battery is placed in the charging unit (low battery only).	<ul style="list-style-type: none">• Make sure the AC adapter is plugged into the charging unit and wall outlet.• Make sure the spare battery is properly seated in the base unit.• Make sure the charging contacts on the handset and charging unit are clean.
Conversation is interrupted frequently.	<ul style="list-style-type: none">• Make sure the base unit antenna is fully vertical.• Move closer to the base unit.• Check for low batt warning.

Table 6-1 Troubleshooting

Problem	Suggestion
Warning tone and NO SERVICE message	<ul style="list-style-type: none">• Move closer to the base unit.
Handset does not ring	<ul style="list-style-type: none">• The lead-acid battery may be weak. Charge the battery pack for eight hours.• Make sure the base unit antenna is fully vertical.• The handset may be too far from the base unit.

NEC

D^{term}[®] Cordless Lite